

In this folder there are 4 executable files, each of these needs to be installed to try and resolve issues with setting up your WHB04B pendant.

Simply double click on the first one and follow the prompts, then proceed to the next until they are all installed.

If at any point it asks you to restart, dismiss the request and proceed to the next installer. After installing the final file, a restart is recommended.

**\*\*It does not matter which order they are installed in but all of them must be installed.**

**\*\*Please ensure you have administrator privileges to install these files.**

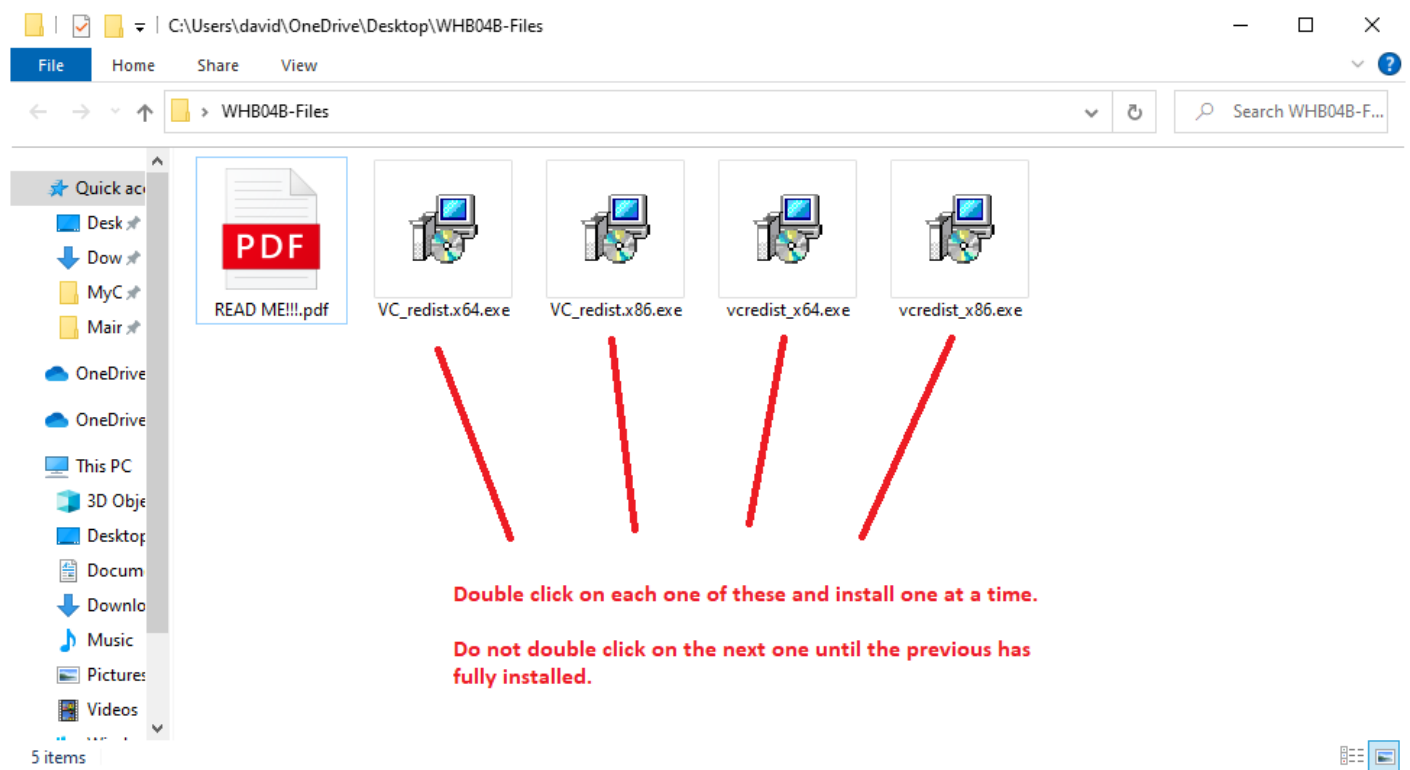

If you have any issues with permissions, instead of double clicking, **Right-click** on each one and go to '**Run as Administrator**'. This will require elevated permissions to install if you do not already have it.

Good luck!

We hope your pendant works after this! :D

If it doesn't, please reach out to our support team.